

## AX105203-S1 Modular Connectors - FX BRILLIANCE UNIVERSAL LC CONNECTOR



For more Information  
please call

1-800-Belden1



### General Description:

FX Brilliance Universal LC Field Installable Connector, Single-mode, OS2, Blue Housing, 1/Pack, with support for 250 um (using Breakout kit), 900 um, 2 mm and 3 mm fiber (using jacketed boots). Includes 900 um boot, other accessories (Breakout Kit & jacketed boots) sold separately.

### Image

Image:

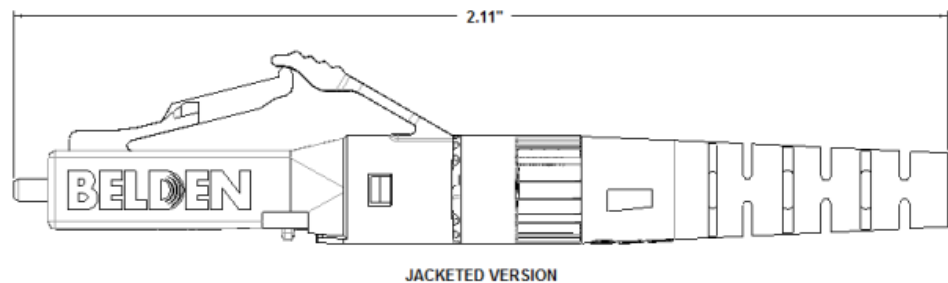
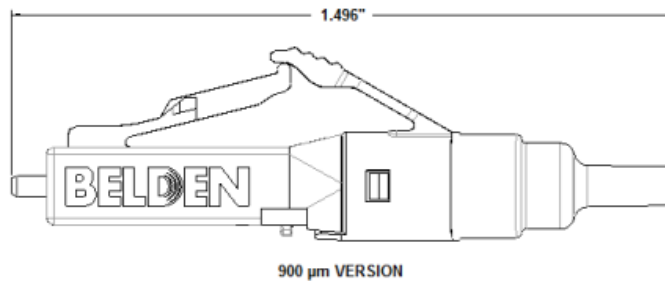
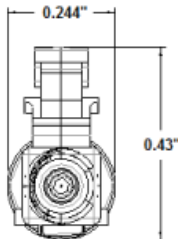

### Usage (Overall)

**Suitable Applications:**

Field-termination of fiber optic cables within Patch Panels, Distribution Frames, Workstation Outlets for FTTD (Fiber to the Desk), drops for FTTH (Fiber to the home) and MDU (Multiple Dwelling Units).

**Related Parts:**

FX Brilliance Precision Installation Kit, Boots for 2mm and 3mm Jacketed Fiber, 250um to 900um

### Physical Characteristics (Connectivity)

#### Materials

Materials:

| Description | Material | Color |
|-------------|----------|-------|
| Boot        | Rubber   | Black |

## METRIC MEASUREMENT VERSION

### AX105203-S1 Modular Connectors - FX BRILLIANCE UNIVERSAL LC CONNECTOR

|                        |         |        |
|------------------------|---------|--------|
| Protective Ferrule cap | Plastic | Opaque |
| Connector Body         | Plastic | Blue   |

#### Weight

**Weight:** 0.003 kg

#### Included Parts

**Included Parts:** 900 µm boot, protective ferrule cap

#### Packaging

**Packaging:** Single (1) connector sample in a sealed plastic bag

### Mechanical Characteristics (Connectivity)

#### Mechanical Specifications:

| Parameters                                      | Specifications                                     |
|---|--|
| Interconnection Compatibility                   | TIA/EIA-604-10A (FOCIS 10)                         |
| Field Assembly Time                             | 40 seconds including fiber preparation             |
| Durability (Multimode)                          | 500 cycles, less than 0.2 dB change, FOTP-21       |
| Durability (Single-mode)                        | 500 cycles, less than 0.3 dB change, FOTP-21       |
| Nominal Fiber OD                                | 125 µm   |
| Storage Temperature                             | -40°F to +140°F (-40°C to +60°C)                   |
| Operating Temperature                           | -40°F to +167°F (-40°C to +75°C)                   |
| Tensile strength on 2 mm Jacketed fiber         | 11.24 lb (5.1 Kg), less than 0.2 dB change, FOTP-6 |
| Tensile strength on 900 µm tight buffered fiber | 1.12 lb (0.5 Kg), less than 0.2 dB change, FOTP-6  |
| Tensile strength on 250um fiber                 | 0.5lb (0.45Kg), less than 0.2 dB change, FOTP-6    |
| Ferrule   | Ceramic  |

### Applicable Specifications and Agency Compliance (Overall)

#### Applicable Standards & Environmental Programs

**EU Directive 2002/95/EC (RoHS):** Yes

**EU RoHS Compliance Date (mm/dd/yyyy):** 07/01/2006

**MIL Order #39 (China RoHS):** EUP 50

**Telecommunications Standards:** TIA 568-C.3

**Safety Listing:** ACA

#### Suitability

**Suitability - Indoor:** Yes - Indoor

### Transmission Characteristics (Connectivity)

#### Transmission Specifications:

| Fiber type      | Maximum Insertion Loss | Typical Insertion Loss | Minimum reflectance @ 1550 nm |
|-----------------|------------------------|------------------------|-------------------------------|
| Multimode       | 0.50 dB                | 0.20 dB                | -30 dB                        |
| Single-mode UPC | 0.50 dB                | 0.30 dB                | -50 dB                        |
| Single-mode APC | 0.50 dB                | 0.30 dB                | -60 dB                        |

### Notes (Overall)

**Notes:** Refer to Installation Guide PX105234 for installation procedures.

**Notes (Cont'd.):** Fiber can be reterminated up to 5 times with the same connector.

### Product Family

#### Part Number List:

| Description   | Color        | Belden Part Number |
|---|--------------|--------------------|
| FX Brilliance Universal LC for OM1 Connector 25/PK      | Beige        | AX105200-B25       |
| FX Brilliance Universal LC for OM1 Sample 1/PK          | Beige        | AX105200-S1        |
| FX Brilliance Universal LC for OM2 Connector 25/PK      | Black        | AX105201-B25       |
| FX Brilliance Universal LC for OM2 Sample 1/PK          | Black        | AX105201-S1        |
| FX Brilliance Universal LC for OM3/OM4 Connector 25/PK  | Aqua         | AX105202-B25       |
| FX Brilliance Universal LC for OM3/OM4 Sample 1/PK      | Aqua         | AX105202-S1        |
| FX Brilliance Universal LC for OM4 Connector 25/PK      | Erika Violet | AX105252-B25       |
| FX Brilliance Universal LC for OM4 Sample 1/PK          | Erika Violet | AX105252-S1        |
| FX Brilliance Universal LC for OS2 Connector 25/PK      | Blue         | AX105203-B25       |
| FX Brilliance Universal LC for OS2 Sample 1/PK          | Blue         | AX105203-S1        |
| FX Brilliance Universal 2mm Boot 25/PK                  | Black        | AX105214-B25       |
| FX Brilliance Universal 3mm Boot 25/PK                  | Black        | AX105215-B25       |
| Breakout Kit 6 fibers                                   | N/A          | AX101100           |
| Breakout Kit 12 fibers                                  | N/A          | AX101101           |
| Breakout Kit 6 fibers for Central Tube Loose Tube Cable | N/A          | AX104695           |

## METRIC MEASUREMENT VERSION

### AX105203-S1 Modular Connectors - FX BRILLIANCE UNIVERSAL LC CONNECTOR

|  |     |          |
|--|-----|----------|
| Breakout Kit 12 fibers for Central Tube Loose Tube Cable | N/A | AX104696 |
|--|-----|----------|

#### Put Ups and Colors:

| Item #      | Putup | Ship Weight | Color | Notes | Item Desc                  |
|-------------|-------|-------------|-------|-------|----------------------------|
| AX105203-S1 | 1 EA  | 0.004 KG    |       |       | FX BR UNIVERSAL LC SM 1/PK |

Revision Number: 0    Revision Date: 08-07-2014

© 2015 Belden, Inc.  
All Rights Reserved.

Although Belden makes every reasonable effort to ensure their accuracy at the time of this publication, information and specifications described herein are subject to error or omission and to change without notice, and the listing of such information and specifications does not ensure product availability. Belden provides the information and specifications herein on an "AS IS" basis, with no representations or warranties, whether express, statutory or implied. In no event will Belden be liable for any damages (including consequential, indirect, incidental, special, punitive, or exemplary damages) whatsoever, even if Belden has been advised of the possibility of such damages, whether in an action under contract, negligence or any other theory, arising out of or in connection with the use, or inability to use, the information or specifications described herein. All sales of Belden products are subject to Belden's standard terms and conditions of sale. Belden believes this product to be in compliance with EU RoHS (Directive 2002/95/EC, 27-Jan-2003). Material manufactured prior to the compliance date may be in stock at Belden facilities and in our Distributor's inventory. The information provided in this Product Disclosure, and the identification of materials listed as reportable or restricted within the Product Disclosure, is correct to the best of Belden's knowledge, information, and belief at the date of its publication. The information provided in this Product Disclosure is designed only as a general guide for the safe handling, storage, and any other operation of the product itself or the one that it becomes a part of. This Product Disclosure is not to be considered a warranty or quality specification. Regulatory information is for guidance purposes only. Product users are responsible for determining the applicability of legislation and regulations based on their individual usage of the product.